

22262108	<b>DATA SHEET</b>	
Valid from: 23.09.2025	<b>AB-C5-M12MA-PG7-SH</b>	

Product description

- Sensor/Actuator connector M12 A-coded
- Angled connector, 5-pole, shielded
- Screw connection, metal knurl, cable screw connection PG7



Product variants:

Article no.	Type	Pole image	Cable clamping range
22262108	Angled cable connector with male contacts	A-coded; 5 pole	4 – 6 mm
22262109	Angled cable coupling with female contacts	A-coded; 5 pole	4 – 6 mm

General properties

Ambient temperature	-40 to +85 °C
Protection degree	IP 67
Coding	A-standard
Number of contacts	5
Outer diameter, cable	4.0 – 6.0 mm
Termination type	screw connection
Termination cross section, mm²	0.25 – 0.75
Mating cycles	≥ 100

Electrical properties

Rated voltage	60 V
Contact resistance	≤ 3 mΩ
Insulation resistance	≥ 100 MΩ
Proof voltage, contact-contact	≥ 1.0 kV
Proof voltage, contact-housing	≥ 1.0 kV
Rated current	4 A
Overvoltage category	II
Pollution degree	3

Materials

Contact carrier	PA
Contact carrier, Inflammability class in acc. to UL 94	HB
Contacts, base material	CuZn
Contacts, surface	Au
Locking nut	Die-cast zinc, Ni plated
Grip body	Die-cast zinc, Ni plated
Sealing	NBR, FPM / FKM, CR

Standards

Product standard	M12-Connector acc. to DIN EN 61076-2-101
------------------	--

Creator: JUKL2 / BU EPIC Released: IVSE1/ BU EPIC	Document: DB22262108EN Version: 00	Page 1 of 3
--	---------------------------------------	-------------

22262108	<b>DATA SHEET</b>	
Valid from: 23.09.2025	<b>AB-C5-M12MA-PG7-SH</b>	

Technical drawings

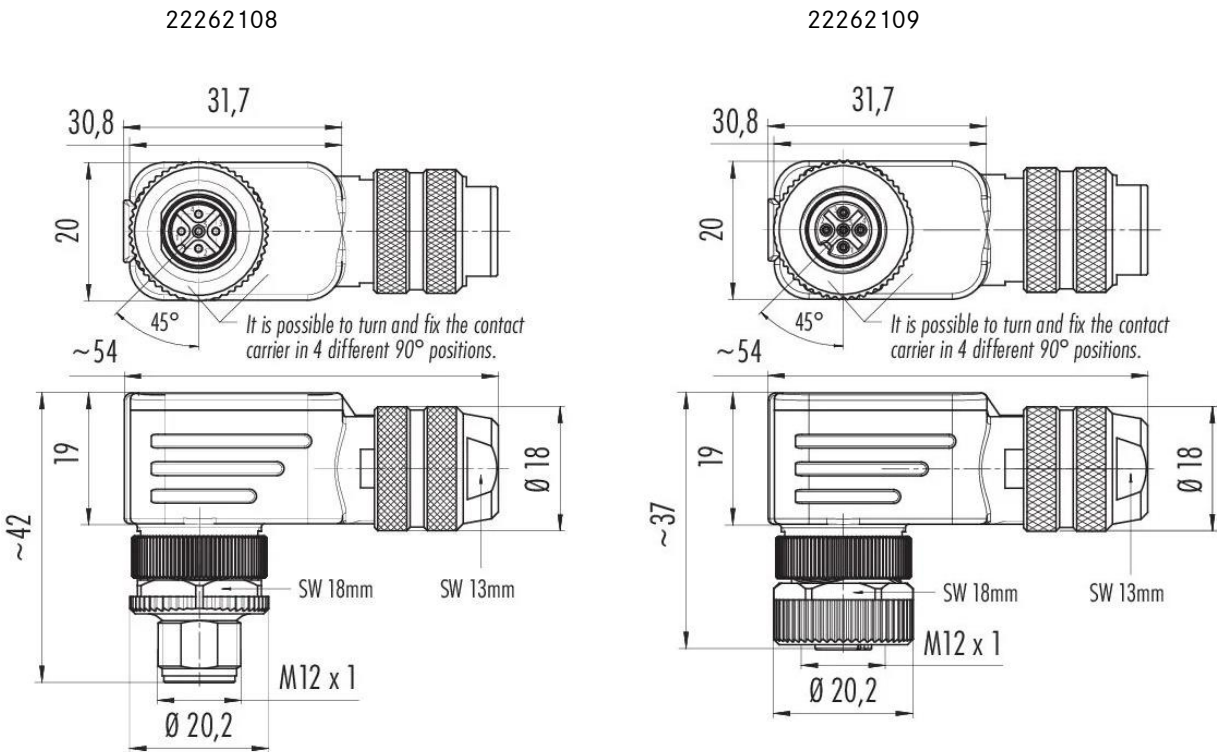

Pole image

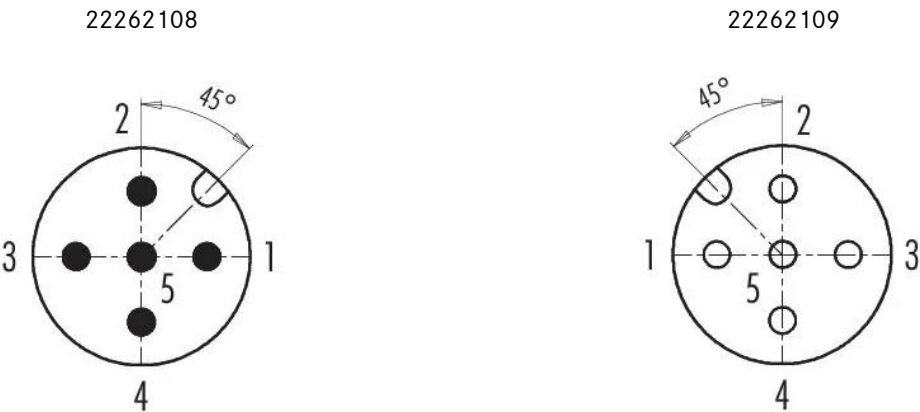

22262108	<b>DATA SHEET</b>	
Valid from: 23.09.2025	<b>AB-C5-M12MA-PG7-SH</b>	

### Assembly instruction:

1. Bead pressing screw, pinch ring, seal and shielding ring to cable.
2. Dismantle cable.
3. Strip single wires, shorten shield and revert to shielding ring.
4. Thread single wires through angled housing, mount shielding ring, seal and pinch ring. Slightly tighten pressing screw to fix the cable.
5. Screw on single wires: 0.4 Nm
6. Screw angled housing to male/ female insert.
7. Fit seal to cover and insert cover.
8. Tighten pressing screw.

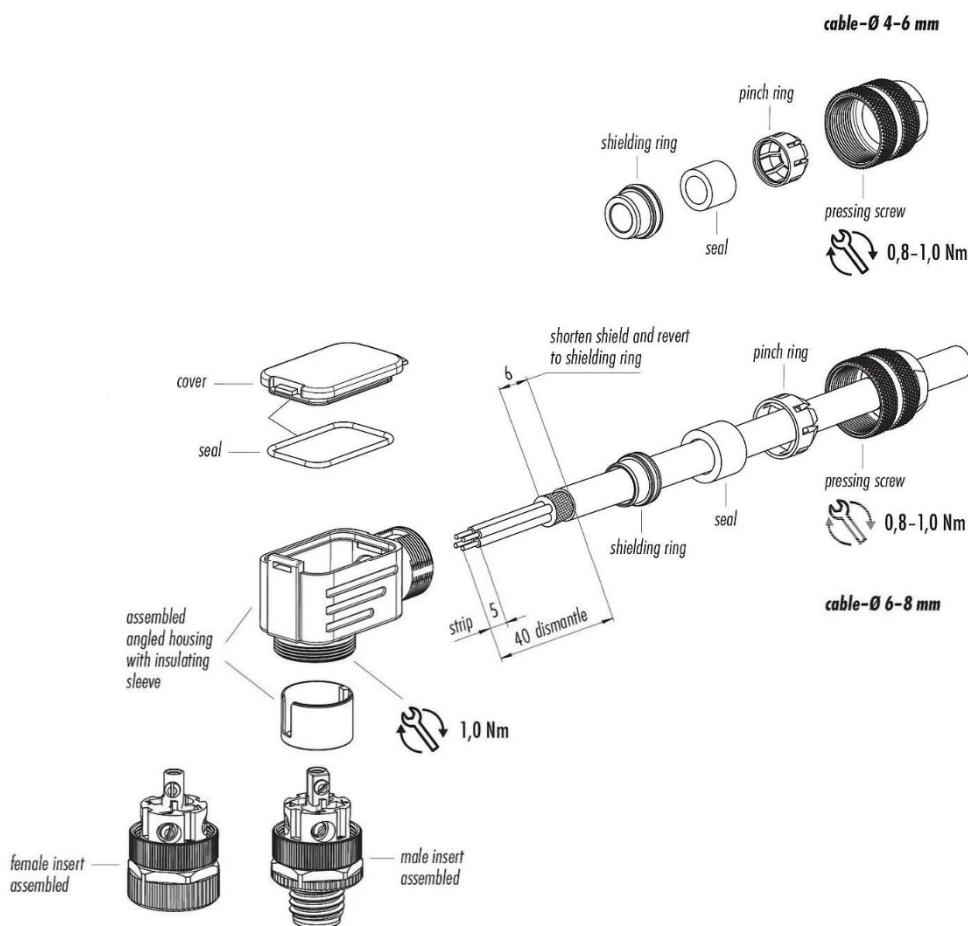

### Note:

Photographs are not true to scale and do not represent detailed images of the respective products.

Creator: JUKL2 / BU EPIC Released: IVSE1/ BU EPIC	Document: DB22262108EN Version: 00	Page 3 of 3
--	---------------------------------------	-------------